

## FEMALE CONNECTOR

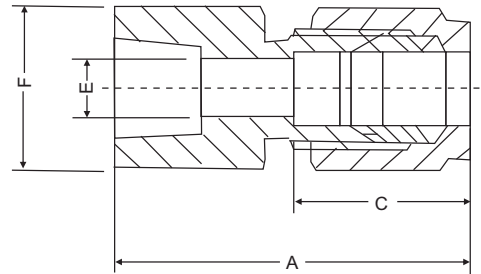

Dimensional Details :



Notes : Drawings are not to scale

Dimension, in.

Tube OD	NPT Female Thread Size	Part Number	A	C	E	F
1/8	1/8	K2CFS2N	1.13	0.50	0.09	9/16
1/8	1/4	K2CFS4N	1.32	0.50	0.09	3/4
1/4	1/8	K4CFS2N	1.23	0.60	0.19	9/16
1/4	1/4	K4CFS4N	1.41	0.60	0.19	3/4
1/4	3/8	K4CFS6N	1.48	0.60	0.19	7/8
1/4	1/2	K4CFS8N	1.67	0.60	0.19	11/16
3/8	1/4	K6CFS4N	1.48	0.66	0.28	3/4
3/8	3/8	K6CFS6N	1.54	0.66	0.28	7/8
3/8	1/2	K6CFS8N	1.73	0.66	0.28	11/16
3/8	3/4	K6CFS12N	1.88	0.66	0.28	15/16
1/2	1/4	K8CFS4N	1.59	0.90	0.41	13/16
1/2	3/8	K8CFS6N	1.65	0.90	0.41	7/8
1/2	1/2	K8CFS8N	1.84	0.90	0.41	11/16
1/2	3/4	K8CFS12N	1.90	0.90	0.41	15/16
3/4	1/2	K12CFS8N	1.84	0.96	0.62	11/16
3/4	3/4	K12CFS12N	1.90	0.96	0.62	15/16
1	3/4	K16CFS12N	2.10	1.23	0.88	13/8
1	1	K16CFS16N	2.45	1.23	0.88	15/8

Dimension, mm.

Tube OD	NPT Female Thread Size	Part Number	A	C	E	F
6	1/4	KM6CFS4N	35.8	15.3	4.8	19
6	3/8	KM6CFS6N	37.6	15.3	4.8	22
6	1/2	KM6CFS8N	42.5	15.3	4.8	27
8	1/4	KM8CFS4N	37.0	16.2	6.4	19
8	3/8	KM8CFS6N	38.5	16.2	6.4	22
8	1/2	KM8CFS8N	43.3	16.2	6.4	27
10	1/4	KM10CFS4N	37.8	17.2	7.9	19
10	3/8	KM10CFS6N	39.4	17.2	7.9	22
10	1/2	KM10CFS8N	44.2	17.2	7.9	27
12	1/4	KM12CFS4N	40.3	22.8	9.5	22
12	3/8	KM12CFS6N	41.9	22.8	9.5	22
12	1/2	KM12CFS8N	46.7	22.8	9.5	27
16	1/2	KM16CFS8N	46.9	24.4	12.7	27
20	1/2	KM20CFS8N	47.9	26.0	15.9	30
20	3/4	KM20CFS12N	49.7	26.0	15.9	35
22	3/4	KM22CFS12N	49.7	26.0	18.3	35
22	1	KM22CFS16N	57.9	26.0	18.3	41
25	3/4	KM25CFS12N	53.4	31.3	21.8	35
25	1	KM25CFS16N	62.3	31.3	21.8	41

**Note:**

- A and C dimensions are typical finger-tight

Dimensions and specifications shown are approximate, may vary from time to time.

Ventil tube fittings are ordered by part numbers as listed in this catalogue and other sizes will be available on request.